

**RICHMOND
COUNTY
AST**

Map 1

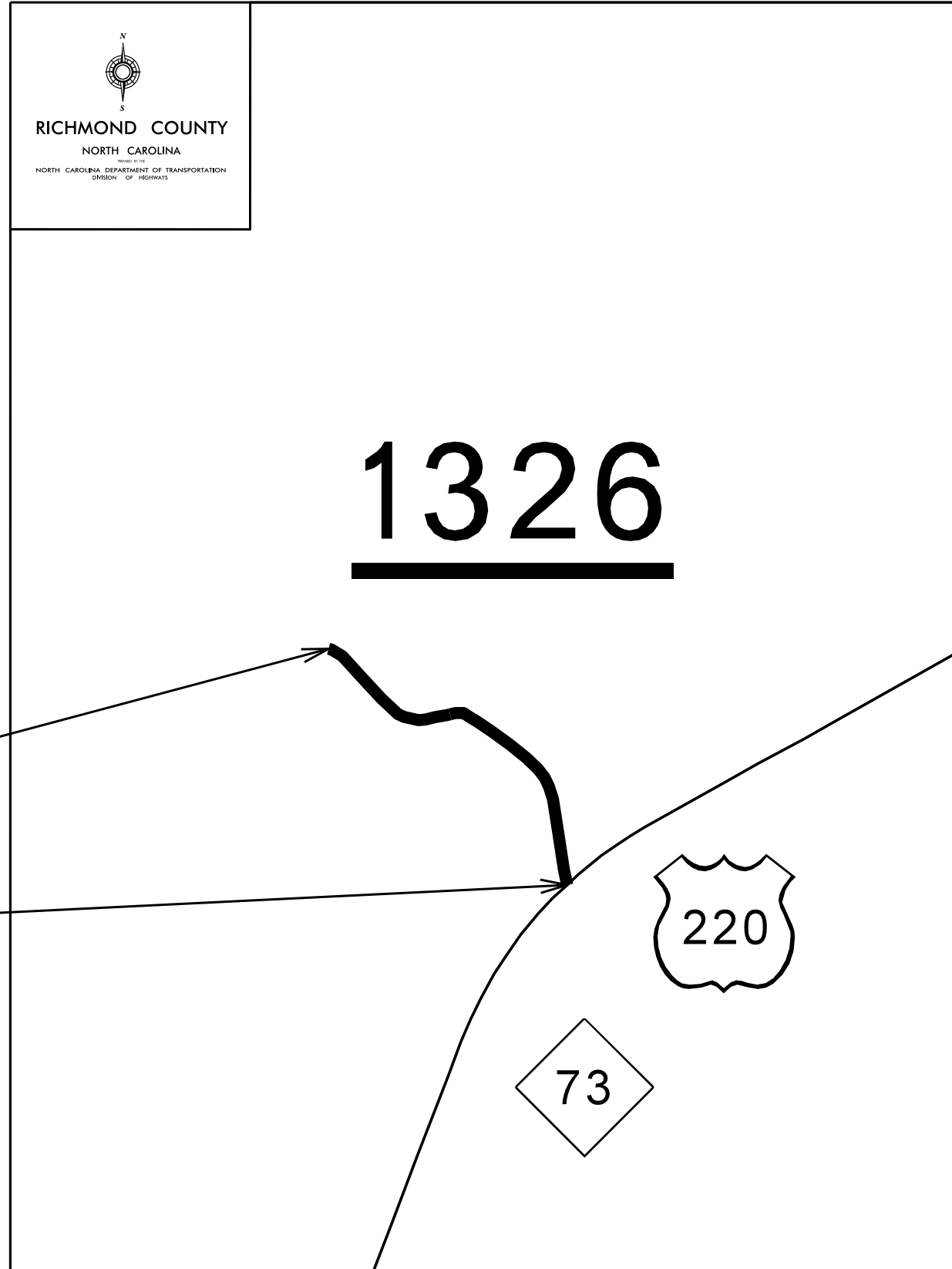

Map 2

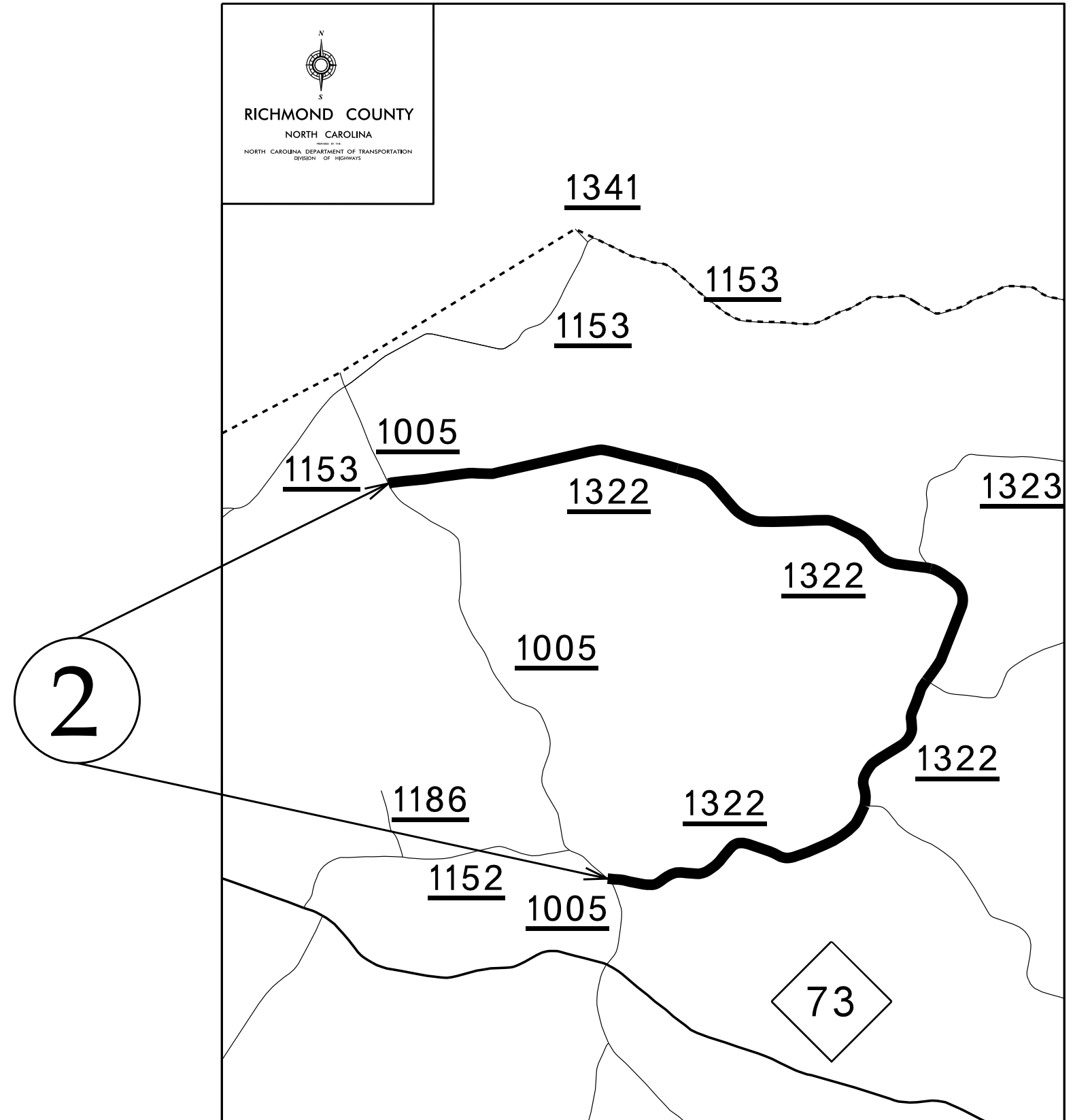

Map 3

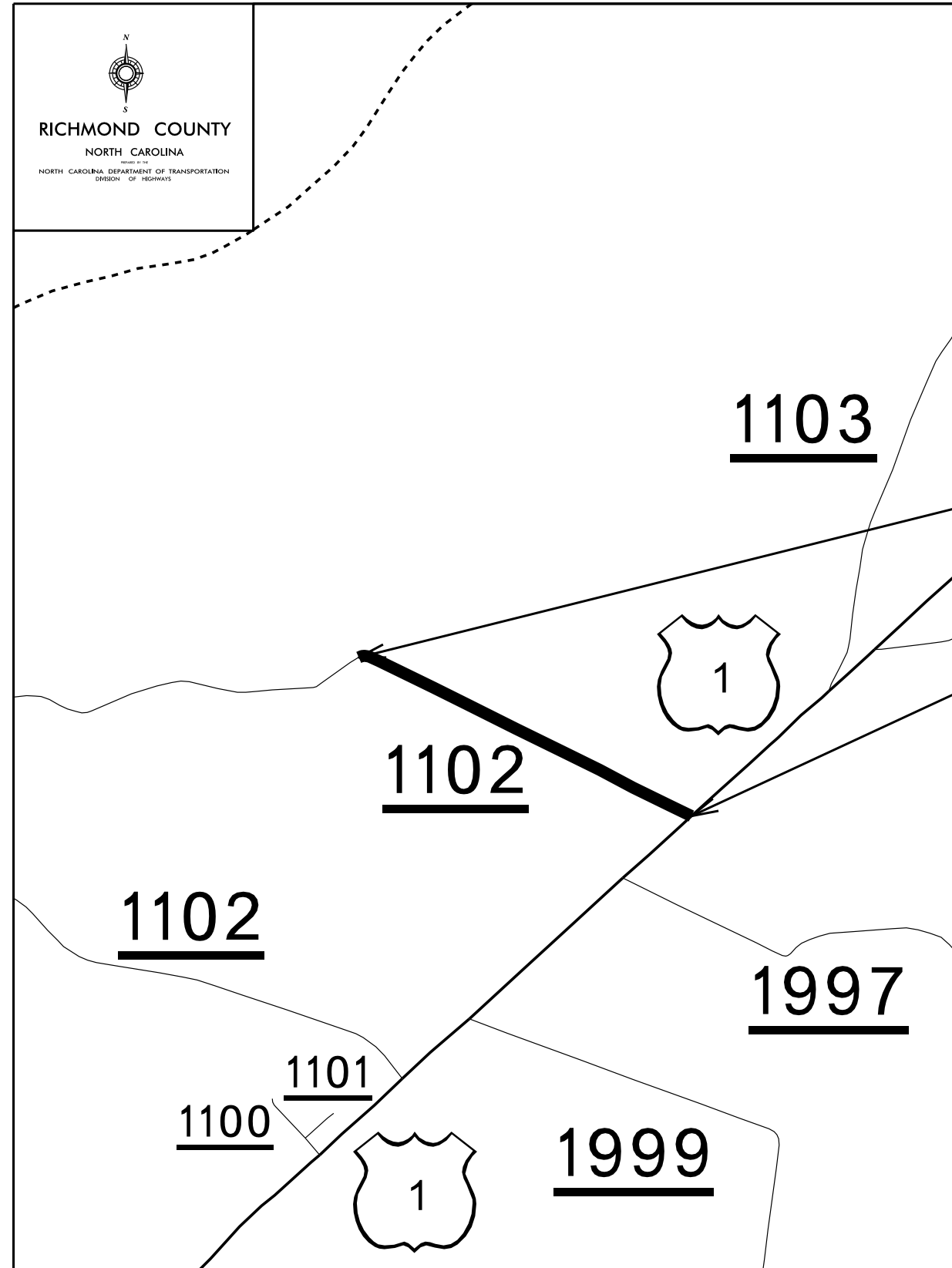

Map 4

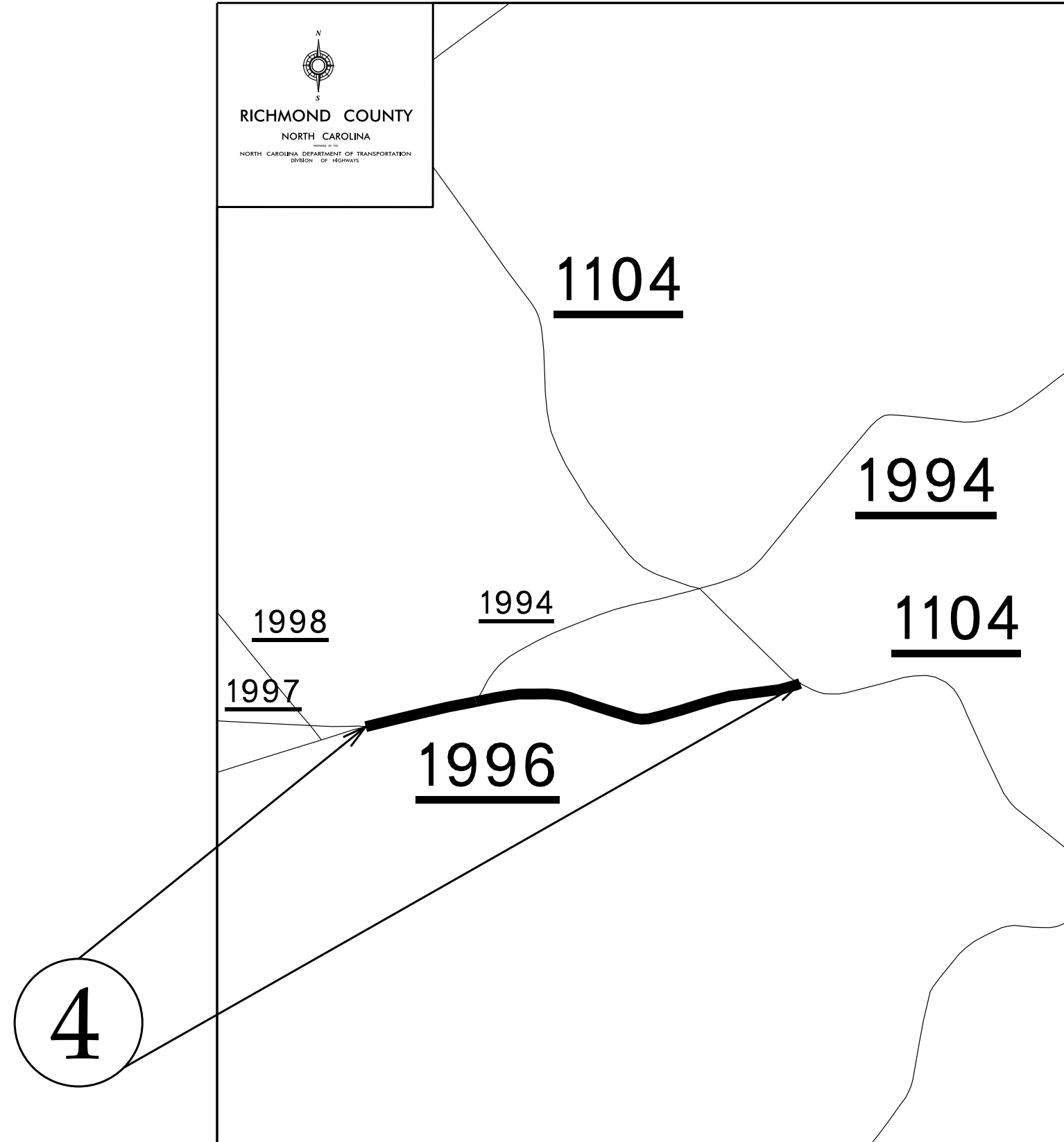

Map 5

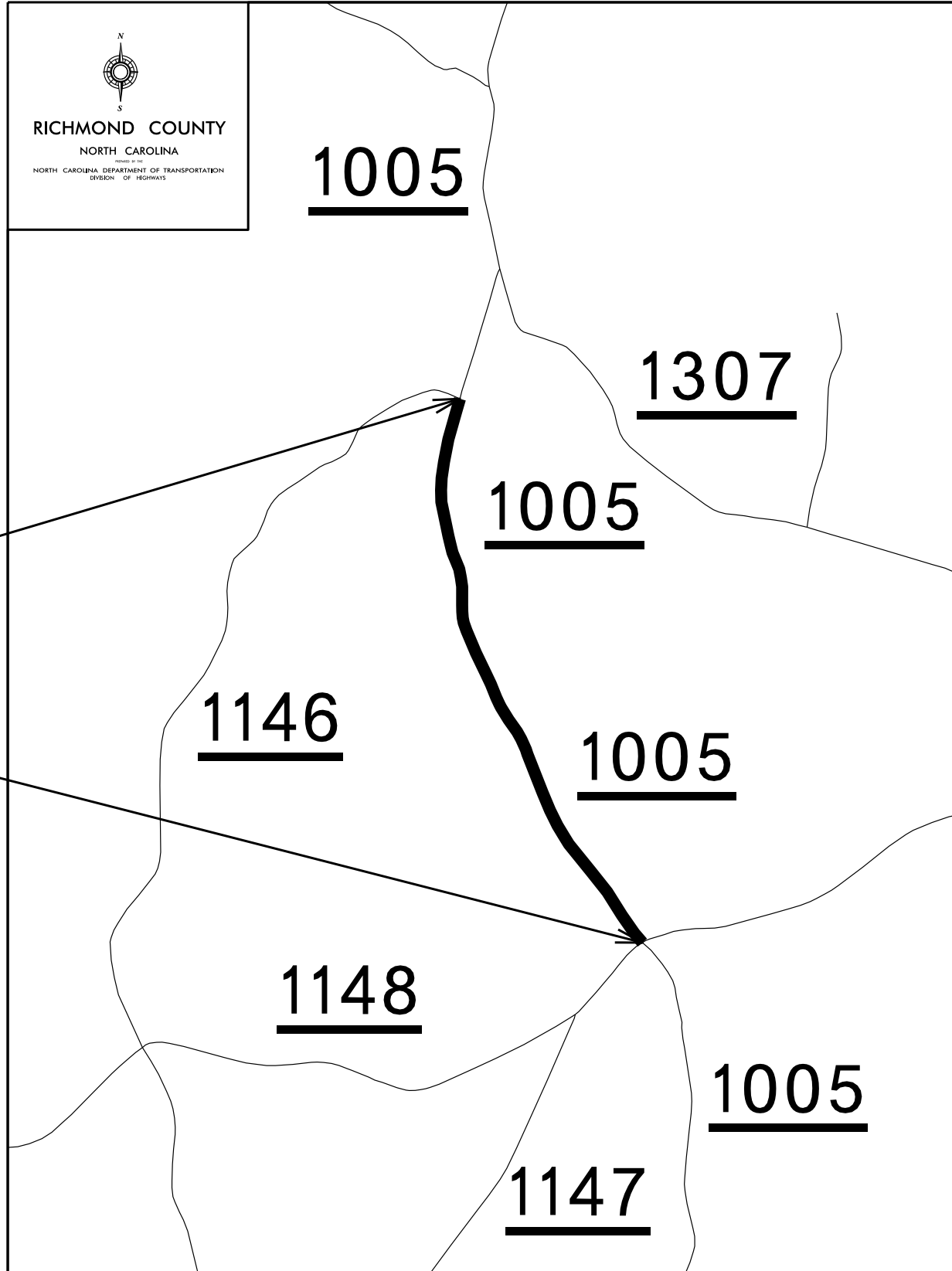

Map 6

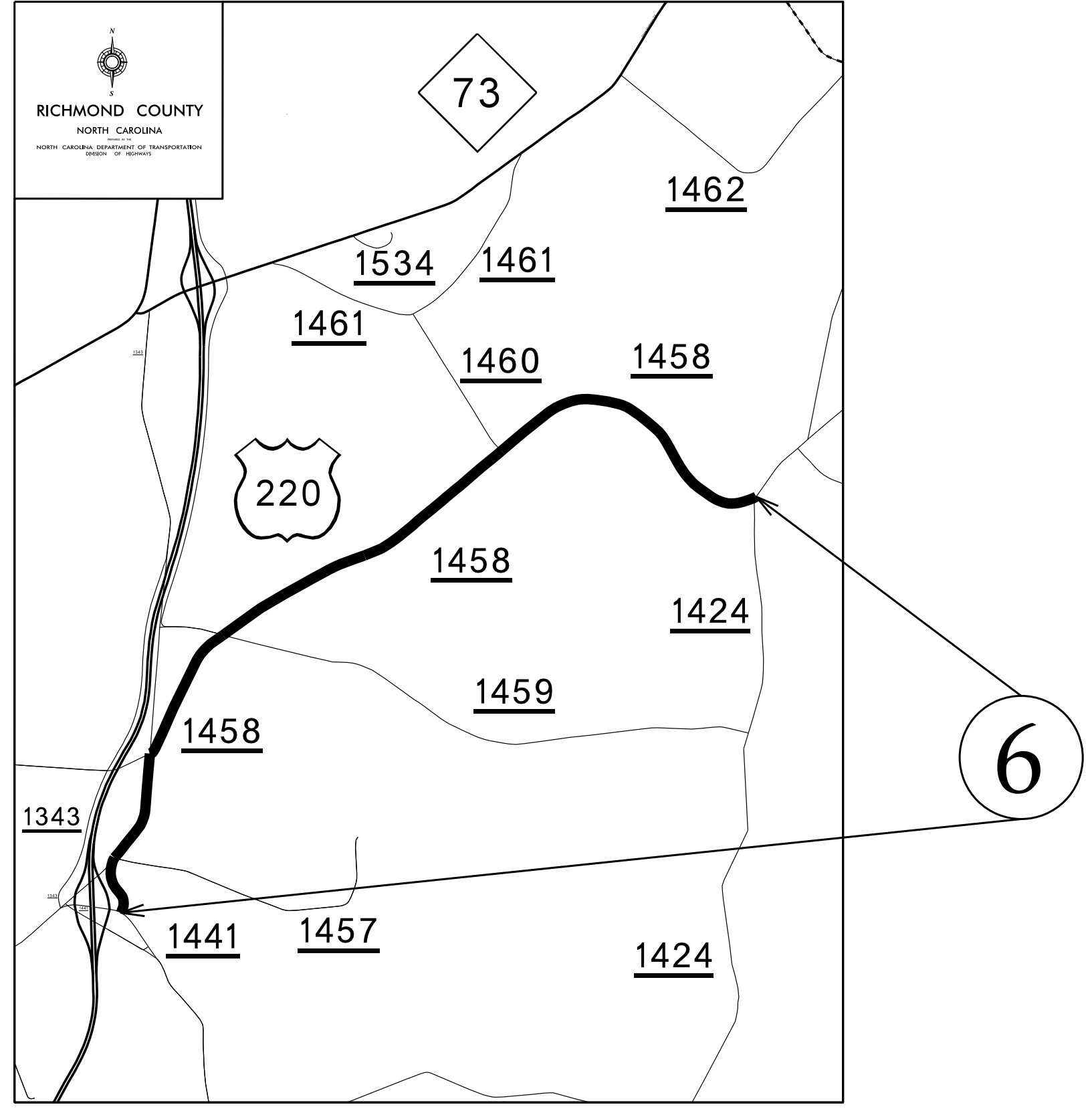

Map 7

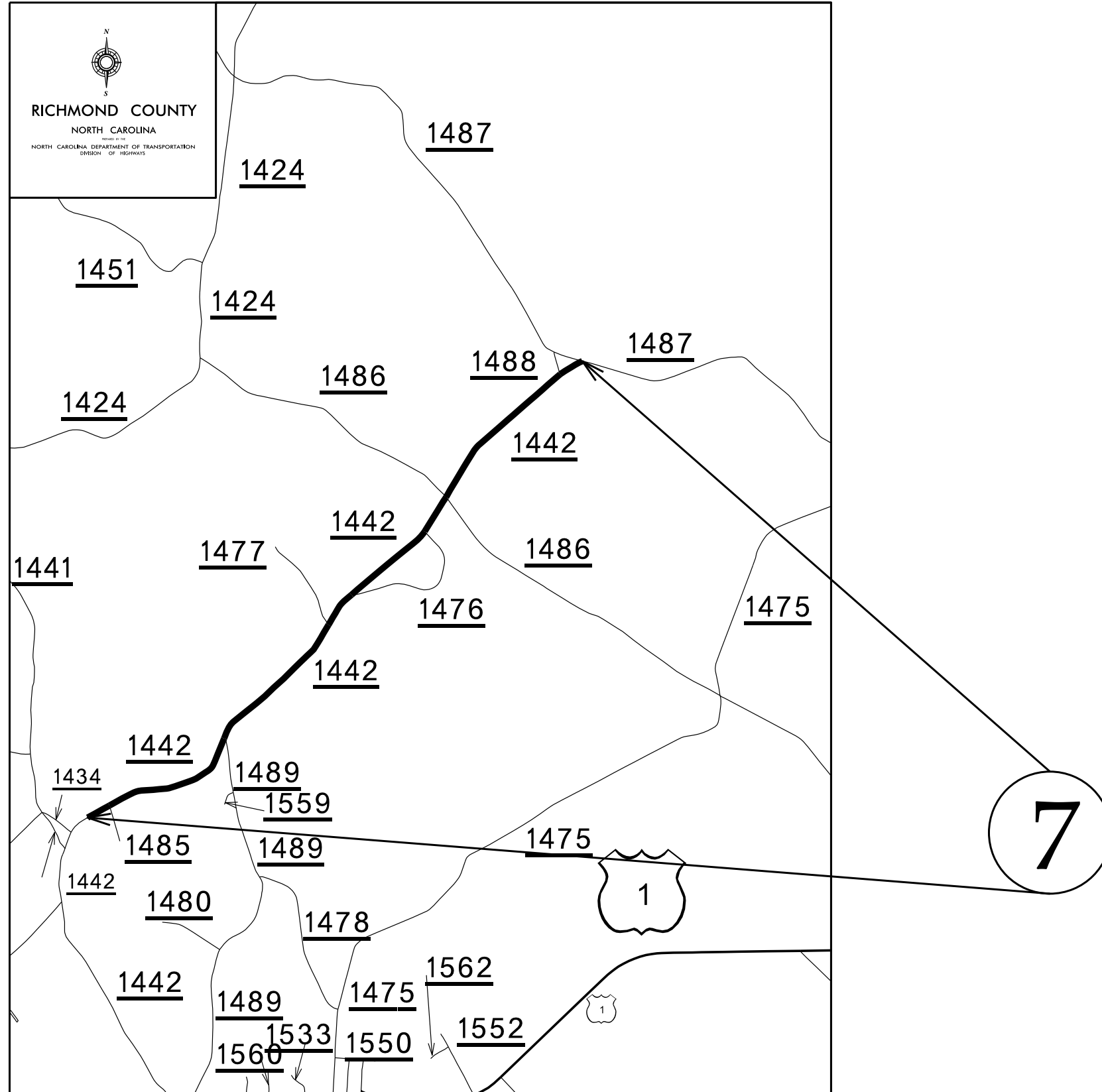

WBS ELEMENT	SHEET NO.
2025CPT.08.02.20772 8.207711	9

Map 8

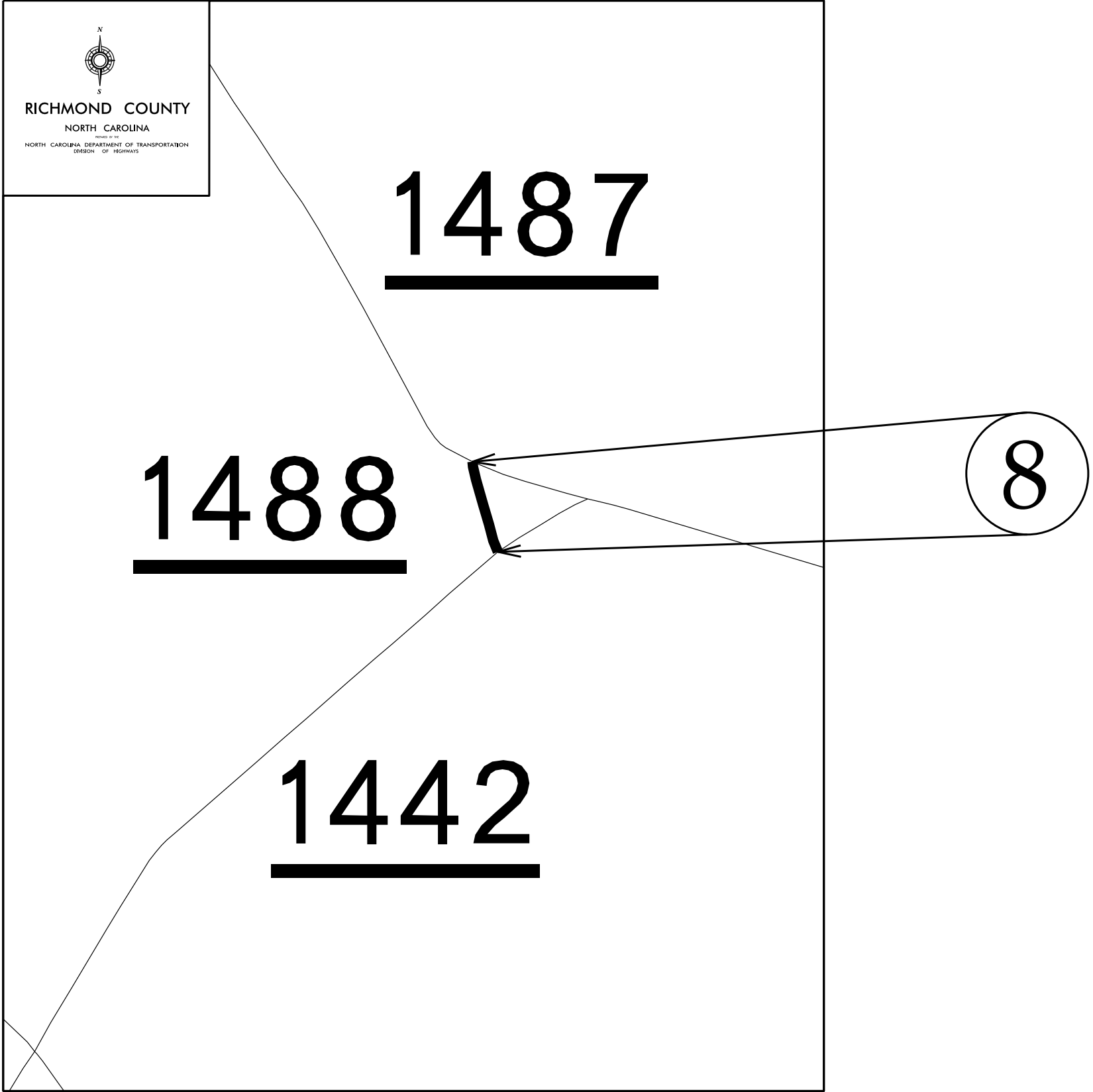

Map 9

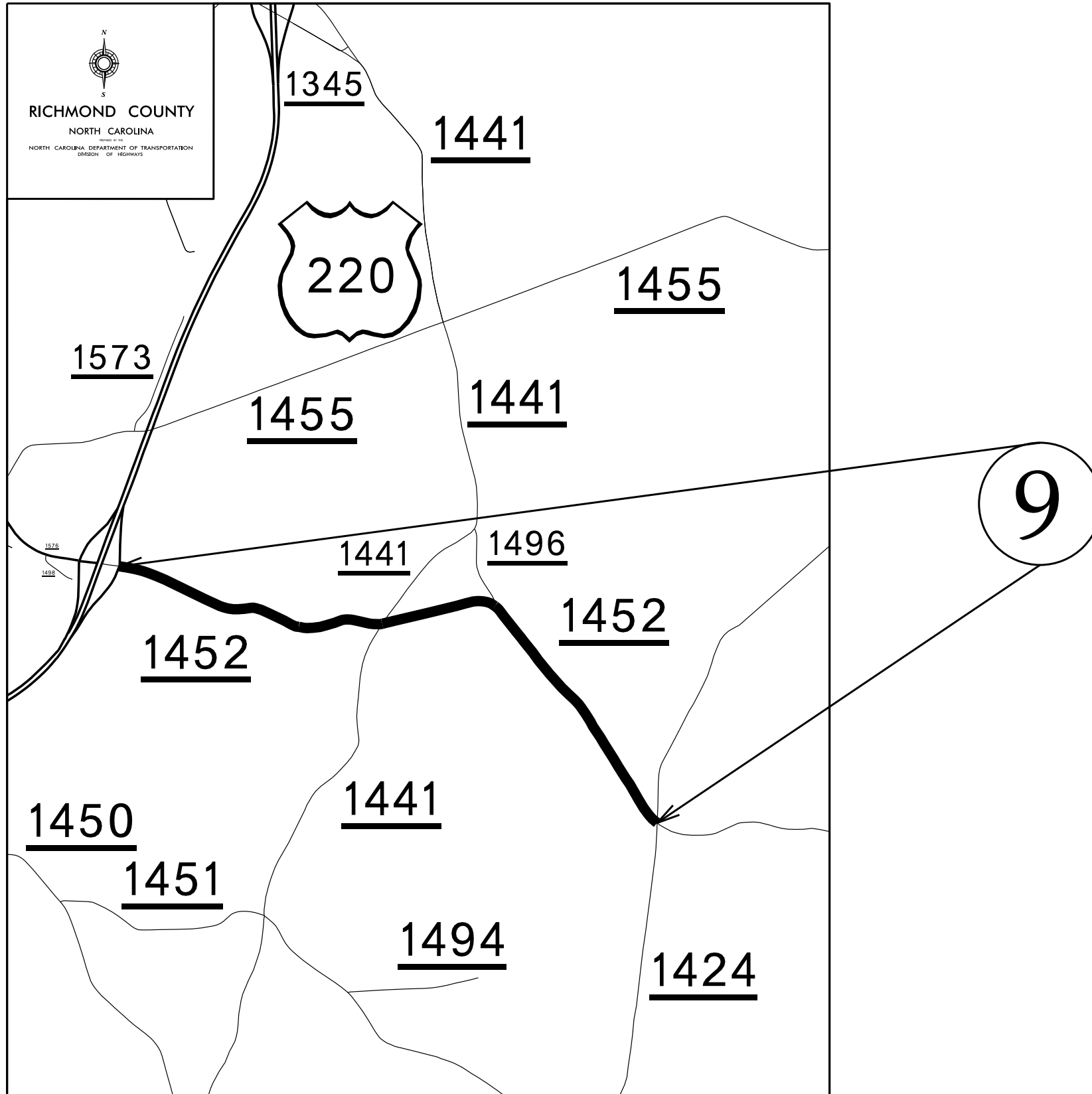

Map 10

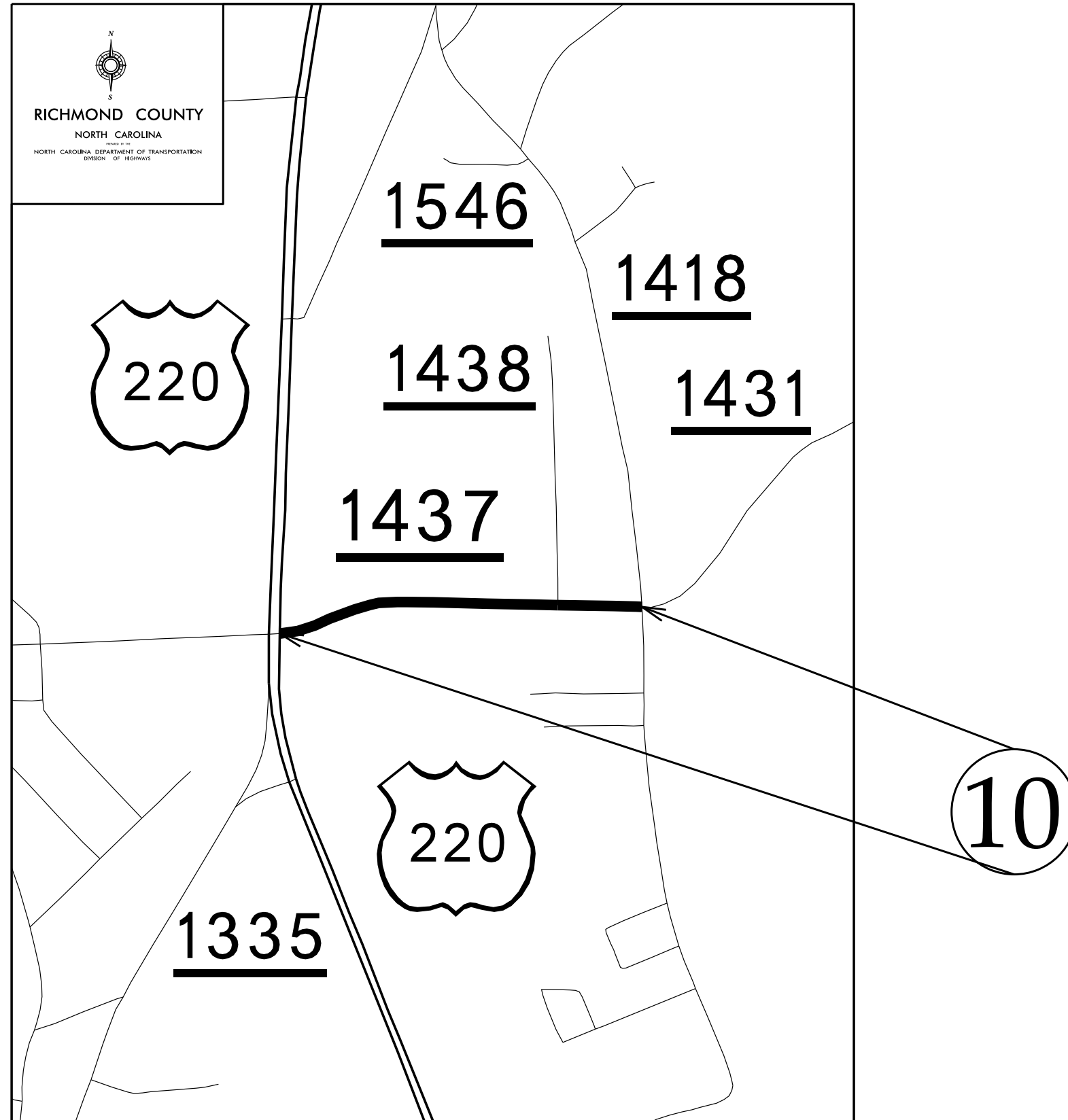

Map 11

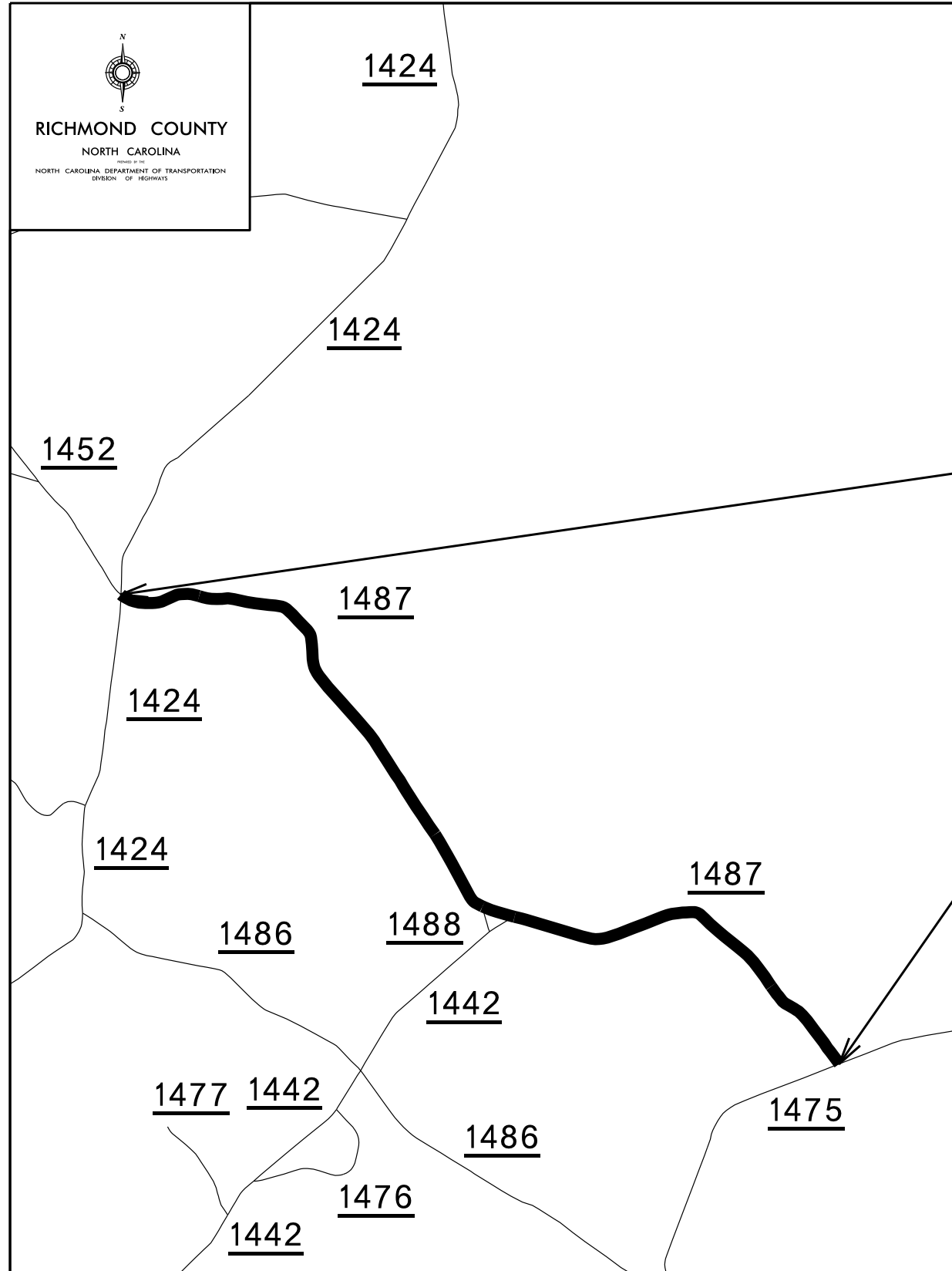

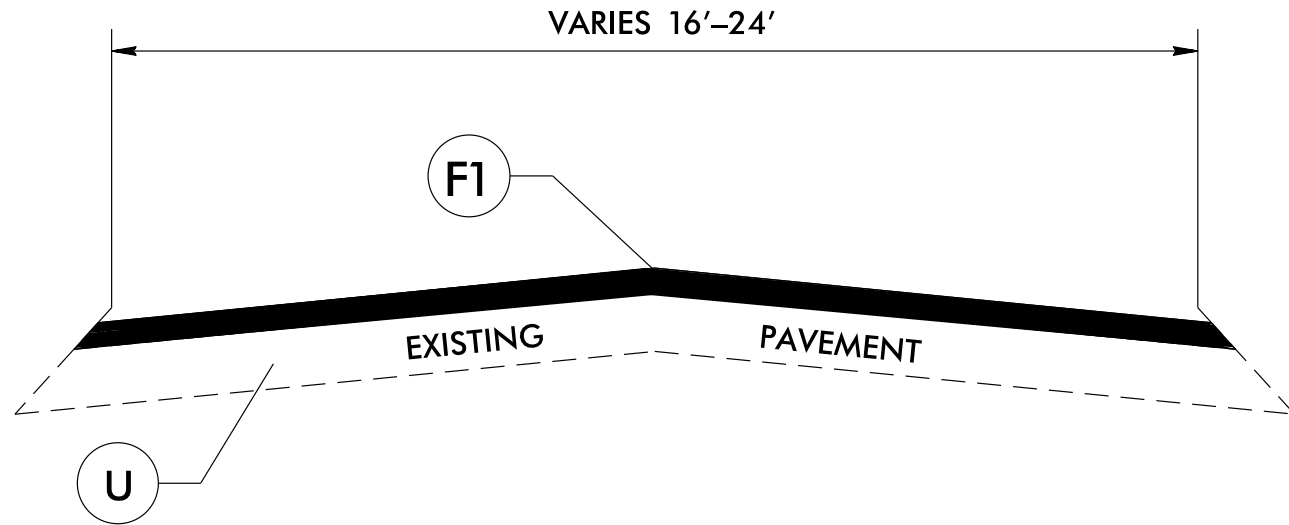

TYPICAL SECTION NO.1

PAVEMENT SCHEDULE	
F1	PROP. ASPHALT SURFACE TREATMENT DOUBLE SEAL
U	EXISTING PAVEMENT

DETAILS OF PATCHING EXISTING PAVEMENT PRIOR TO RESURFACING

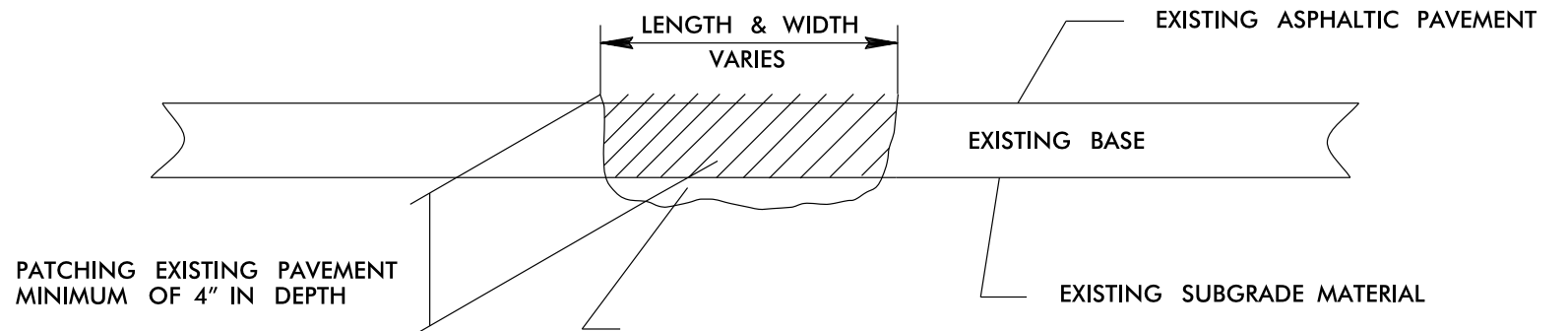

SAW AND REMOVE EXISTING ASPHALT PAVEMENT TO NEAT LINES AND REMOVE EXISTING LOOSE BASE AND/OR SUBGRADE MATERIAL AND REPLACE WITH ASPHALT CONCRETE BASE COURSE B-25.0C OR I-19.0C, AS DIRECTED BY THE ENGINEER

040357 025 AUG 2024 13:57 025 aep1 Richmond September 2024 AST Maps Tlp.dgn 2025 August 21 11:04:24

PROJECT NO.	SHEET NO.	TOTAL NO.
2025CPT.08.02.20772, 8.207711	14	

SUMMARY OF QUANTITIES

PROJECT NO	COUNTY	MAP NO	ROUTE	DESCRIPTION	TYP NO	LANES	LANE TYPE	FINAL SURFACE TESTING REQUIRED	WARM MIX ASPHALT REQUIRED	LENGTH	WIDTH	BEGIN MP	END MP	1575000000-E	1704000000-E	1803500000-E	1838000000-E	1838500000-N
														ASPHALT BINDER FOR PLANT MIX	PATCHING EXISTING PAVEMENT	ASPHALT SURFACE TREATMENT, DOUBLE SEAL	EMULSION FOR ASPHALT SURFACE TREATMENT	VACUUM TRUCK
														TONS	TONS	SY	GAL	WK
2025CPT.08.02.20772	Richmond	1	SR-1326 / DOC MCLEAN RD	FROM US 220 TO END OF PAVEMENT	1	2	2WU	NO	NO	0.29	26	0	0.29			4,423.00	2,433	
TOTAL FOR MAP NO. 1										0.29						4,423.00	2,433	
2025CPT.08.02.20772	Richmond	2	SR-1322 / CONCORD CHURCH RD	FROM SR 1005 (CARTLEDGE CREEK RD) TO SR 1005 (CARTLEDGE CREEK RD)	1	2	2WU	NO	NO	5.89	16	0	5.89	3	61	55,287.00	30,408	
TOTAL FOR MAP NO. 2										5.89				3	61	55,287.00	30,408	
2025CPT.08.02.20772	Richmond	3	SR-1102 / HORSESHOE RD	FROM BEGINNING OF PAVEMENT TO US HWY 1	1	2	2WU	NO	NO	0.89	18	3.47	4.36	1	13	9,398.00	5,169	
TOTAL FOR MAP NO. 3										0.89				1	13	9,398.00	5,169	
2025CPT.08.02.20772	Richmond	4	SR-1996 / FAIRLY HAYES RD	FROM SR 1997 (ST. STEPHENS CHURCH RD) TO SR 1104 (OSBORNE RD)	1	2	2WU	NO	NO	1.3	18	2	3.3			13,278.00	7,550	*
TOTAL FOR MAP NO. 4										1.3						13,278.00	7,550	
2025CPT.08.02.20772	Richmond	5	SR-1005 / CARTLEDGE CREEK RD	FROM SR 1146 (HOLLY GROVE CHURCH RD) TO SR 1148 (GRASSY ISLAND RD)	1	2	2WU	NO	NO	1.61	22	8.08	9.69		5	20,780.00	11,429	
TOTAL FOR MAP NO. 5										1.61					5	20,780.00	11,429	
2025CPT.08.02.20772	Richmond	6	SR-1458 / DERBY WAY	FROM SR 1424 (GIBSON MILL RD) TO SR 1441 (HAYWOOD PARKER RD)	1	2	2WU	NO	NO	4.95	24	0	4.95		5	69,696.00	38,333	
TOTAL FOR MAP NO. 6										4.95					5	69,696.00	38,333	
TOTAL FOR PROJ NO. 2025CPT.08.02.20772										14.93				4	84	172,862.00	95,322	9.00
8.207711	Richmond	7	SR-1442 / LEDBETTER RD	FROM BRIDGE #51 OVER LEDBETTER LAKE TO SR 1487 (MILLSTONE RD)	1	2	2WU	NO	NO	4.3	24	2.22	6.52		5	60,544.00	33,299	
TOTAL FOR MAP NO. 7										4.3					5	60,544.00	33,299	
8.207711	Richmond	8	SR-1488 / BEAVERDAM CREEK RD	FROM SR 1442 (LEDBETTER RD) TO SR 1487 (MILLSTONE RD)	1	2	2WU	NO	NO	0.15	23	0	0.15		5	2,024.00	1,113	
TOTAL FOR MAP NO. 8										0.15					5	2,024.00	1,113	
8.207711	Richmond	9	SR-1452 / MILLSTONE RD	FROM I-73 (US HWY 220 BYPASS) TO SR 1424 (GIBSON MILL RD)	1	2	2WU	NO	NO	2.423	28	2.4	4.823	6	118	39,802.00	21,891	*
TOTAL FOR MAP NO. 9										2.423				6	118	39,802.00	21,891	
8.207711	Richmond	10	SR-1437 / SNEAD AVE	FROM US HWY 220 (N US 220 HWY) TO SR 1418 (NORTHAM RD)	1	2	2WU	NO	NO	0.55	22	0	0.55		5	7,099.00	3,904	
TOTAL FOR MAP NO. 10										0.55					5	7,099.00	3,904	
8.207711	Richmond	11	SR-1487 / MILLSTONE RD	FROM SR 1424 (GIBSON MILL RD) TO SR 1475 (MCDONALD CHURCH RD)	1	2	2WU	NO	NO	5.3	24	0	5.3		5	74,624.00	41,043	
TOTAL FOR MAP NO. 11										5.3					5	74,624.00	41,043	
TOTAL FOR PROJ NO. 8.207711										12.723				6	138	184,093.00	101,250	9.00
GRAND TOTAL										27.653				10	222	356,955.00	196,572	18.00

PROJECT NO.	SHEET NO.	TOTAL NO.
2025CPT.08.02.20772, 8.207711	15	

THERMOPLASTIC AND PAINT QUANTITIES

PROJECT NO	COUNTY	MAP NO	ROUTE	DESCRIPTION	TYP NO	LANES	LANE TYPE	LENGTH	WIDTH	BEGIN MP	END MP	4413000000-E	4457000000-N	4815000000-E	4815000000-E
								MI	FT			WORK ZONE ADVANCE/GENERAL WARNING SIGNING	TEMPORARY TRAFFIC CONTROL	6" WHITE PAINT	6" YELLOW PAINT
												SF	LS	LF	LF
2025CPT.08.02.20772	Richmond	1	SR-1326 / DOC MCLEAN RD	FROM US 220 TO END OF PAVEMENT	1	2	2WU	0.29	26	0	0.29	32			
TOTAL FOR MAP NO. 1								0.29				32			
2025CPT.08.02.20772	Richmond	2	SR-1322 / CONCORD CHURCH RD	FROM SR 1005 (CARTLEDGE CREEK RD) TO SR 1005 (CARTLEDGE CREEK RD)	1	2	2WU	5.89	16	0	5.89	660		124,198	112,760
TOTAL FOR MAP NO. 2								5.89				660		124,198	112,760
2025CPT.08.02.20772	Richmond	3	SR-1102 / HORSESHOE RD	FROM BEGINNING OF PAVEMENT TO US HWY 1	1	2	2WU	0.89	18	3.47	4.36	100		18,780	9,252
TOTAL FOR MAP NO. 3								0.89				100		18,780	9,252
2025CPT.08.02.20772	Richmond	4	SR-1996 / FAIRLY HAYES RD	FROM SR 1997 (ST. STEPHENS CHURCH RD) TO SR 1104 (OSBORNE RD)	1	2	2WU	1.3	18	2	3.3	225	*	28,126	26,140
TOTAL FOR MAP NO. 4								1.3				225		28,126	26,140
2025CPT.08.02.20772	Richmond	5	SR-1005 / CARTLEDGE CREEK RD	FROM SR 1146 (HOLLY GROVE CHURCH RD) TO SR 1148 (GRASSY ISLAND RD)	1	2	2WU	1.61	22	8.08	9.69	180		32,860	32,800
TOTAL FOR MAP NO. 5								1.61				180		32,860	32,800
2025CPT.08.02.20772	Richmond	6	SR-1458 / DERBY WAY	FROM SR 1424 (GIBSON MILL RD) TO SR 1441 (HAYWOOD PARKER RD)	1	2	2WU	4.95	24	0	4.95	554		104,464	87,930
TOTAL FOR MAP NO. 6								4.95				554		104,464	87,930
TOTAL FOR PROJ NO. 2025CPT.08.02.20772								14.93				1,751	1.0000	308,428	268,882
8.207711	Richmond	7	SR-1442 / LEDBETTER RD	FROM BRIDGE #51 OVER LEDBETTER LAKE TO SR 1487 (MILLSTONE RD)	1	2	2WU	4.3	24	2.22	6.52	478		91,270	68,722
TOTAL FOR MAP NO. 7								4.3				478		91,270	68,722
8.207711	Richmond	8	SR-1488 / BEAVERDAM CREEK RD	FROM SR 1442 (LEDBETTER RD) TO SR 1487 (MILLSTONE RD)	1	2	2WU	0.15	23	0	0.15	17		2,800	2,800
TOTAL FOR MAP NO. 8								0.15				17		2,800	2,800
8.207711	Richmond	9	SR-1452 / MILLSTONE RD	FROM I-73 (US HWY 220 BYPASS) TO SR 1424 (GIBSON MILL RD)	1	2	2WU	2.423	28	2.4	4.823	327	*	49,790	43,772
TOTAL FOR MAP NO. 9								2.423				327		49,790	43,772
8.207711	Richmond	10	SR-1437 / SNEAD AVE	FROM US HWY 220 (N US 220 HWY) TO SR 1418 (NORTHAM RD)	1	2	2WU	0.55	22	0	0.55	56		10,896	8,220
TOTAL FOR MAP NO. 10								0.55				56		10,896	8,220
8.207711	Richmond	11	SR-1487 / MILLSTONE RD	FROM SR 1424 (GIBSON MILL RD) TO SR 1475 (MCDONALD CHURCH RD)	1	2	2WU	5.3	24	0	5.3	594		112,208	95,700
TOTAL FOR MAP NO. 11								5.3				594		112,208	95,700
TOTAL FOR PROJ NO. 8.207711								12.723				1,472	1.000	266,964	219,214
GRAND TOTAL								27.653				3,223	1.000	575,392	488,096

SIGNING FOR ASPHALT SURFACE TREATMENT

LEGEND

- ◻ PORTABLE SIGN
- └ STATIONARY SIGN
- ← DIRECTION OF TRAFFIC FLOW

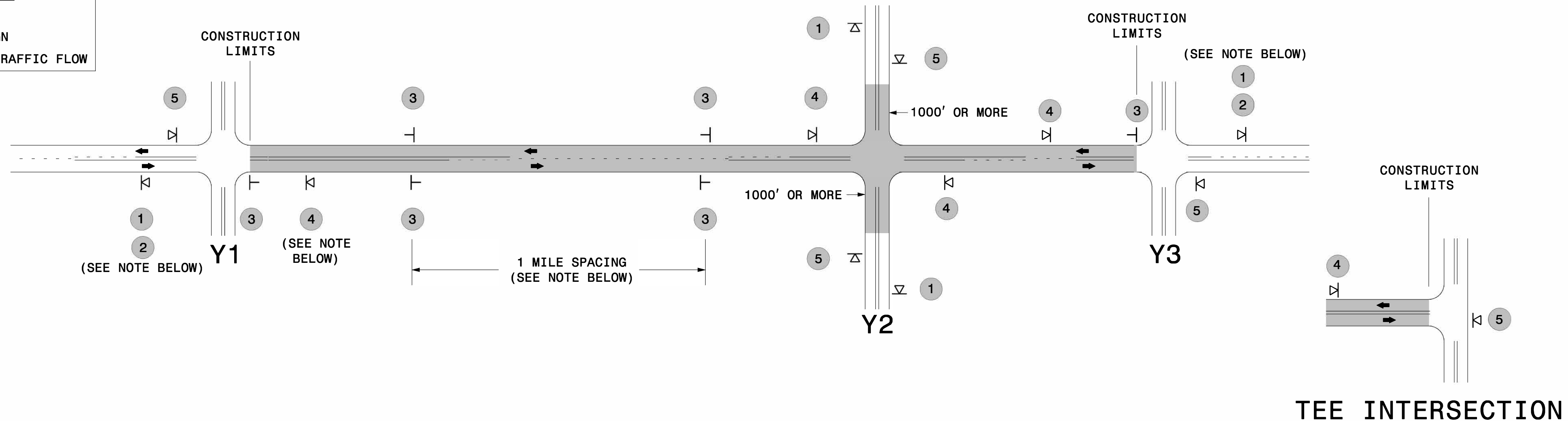

MAINLINE (-L-) SIGNING

-Y- LINE SIGNING

SIGNING NOTES AND PLACEMENT PER DIRECTION	1	 W20-1 48" X 48"	- PLACE 1000' PRIOR TO BEGINNING OF CONSTRUCTION LIMITS. ONLY USED ON -Y- LINES IF RESURFACING LIMITS EXTEND 1000' ALONG -Y- LINE.	<p>STATIONARY SIGNING NOT REQUIRED FOR THE FOLLOWING -Y- LINE CONDITIONS:</p> <ol style="list-style-type: none"> 1) LESS THAN 1000' OF RESURFACING ALONG -Y- LINE 2) SUBDIVISION ROADS 3) DEAD END ROADS <p>WHEN PAVING/CONSTRUCTION ACTIVITIES PROCEED ACROSS AN UNSIGNED -Y- LINE, PORTABLE ADVANCE WARNING SIGNS SHALL BE USED ALONG THE -Y- LINE AS SHOWN BELOW. REMOVE UPON COMPLETION OF WORK.</p> <div style="display: flex; justify-content: space-around; align-items: center;"> <div style="text-align: center;"> <p>W20-1 48" X 48"</p> <p>PLACED 500' IN ADVANCE OF FLAGGER.</p> </div> <div style="text-align: center;"> <p>W20-7 A 48" X 48"</p> <p>PLACED 250' IN ADVANCE OF FLAGGER.</p> </div> </div>
	2	 W7-3aP 24" X 18"	- SIGN #2 ONLY USED WHEN RESURFACING LIMITS ARE 2 OR MORE MILES IN LENGTH. ROUND UP TO THE NEAREST WHOLE NUMBER. DO NOT USE FRACTIONAL OR DECIMAL NUMBERS.	
	3	 W8-7 48" X 48"	- ALTERNATE THE FOLLOWING TWO SIGNS: - STARTING WITH "LOOSE GRAVEL" (W8-7) FOLLOWED BY "UNMARKED PAVEMENT". - PLACE INITIALLY AT THE CONSTRUCTION LIMITS AND SPACED 1 MILE APART THEREAFTER.	
		 SP 48" X 48"	- AT TEE INTERSECTIONS INSTALL INITIALLY 0.5 MILE FROM INTERSECTION AND SPACE 1 MILE APART THEREAFTER.	
	4	 SP 13106 48" X 48"	- THESE ARE FOR -Y- LINES THAT ARE "THROUGH" ROADWAYS. DEAD END AND SUBDIVISION ROADS ARE NOT "THROUGH" ROADWAYS. - INSTALL 500' +/- FROM EACH -Y- LINE APPROACH AS SHOWN ABOVE. - FOR MULTIPLE -Y- LINES THAT ARE SEPARATED BY 0.25 MILES OR LESS, TREAT AS A SINGLE UNIT AND INSTALL WITHIN 500' OF EACH APPROACH. - A MAXIMUM OF 2 SIGN SETS PER MILE. DO NOT INSTALL WHEN -Y- LINES ARE WITHIN 0.5 MILES FROM "END ROAD WORK" SIGN.	
5	 G20-2 A 48" X 24"	PLACE 500' FOLLOWING THE END OF CONSTRUCTION LIMITS OR AS SHOWN WHEN WORK ENDS AT A 3-WAY TEE INTERSECTION.		

THE ABOVE SIGNS ARE ALL THAT ARE REQUIRED FOR A CONTRACTOR TO BEGIN A RESURFACING CONTRACT. ANY ADDITIONAL SIGNS REQUESTED BY NCDOT DIVISIONS SHALL BE INSTALLED WITHIN 7 BUSINESS DAYS OF THE START OF CONTRACT WORK.

MAPS LESS THAN 2 MILES

FOR AST RESURFACING MAPS WITH CONSTRUCTION LIMITS LESS THAN 2 MILES IN LENGTH, USE A STATIONARY "LOOSE GRAVEL" SIGN AT THE BEGINNING CONSTRUCTION LIMIT FOLLOWED BY AN "UNMARKED PAVEMENT" SIGN MIDWAY THROUGH AND AN "END ROAD WORK" SIGN AT THE END CONSTRUCTION LIMIT.

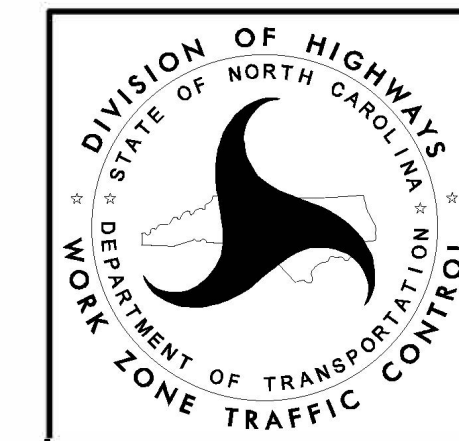

ADVANCE WARNING SIGNS FOR 2-LANE ROADWAY ASPHALT SURFACE TREATMENT

5/12/2017 S:\TMD\WZTC\Resurfacing\2L2W & AST Resurfacing Details\Resurfacing_AdvWarn_2Ln - AST.dgn User:kddis